

ANGLE SHOWER

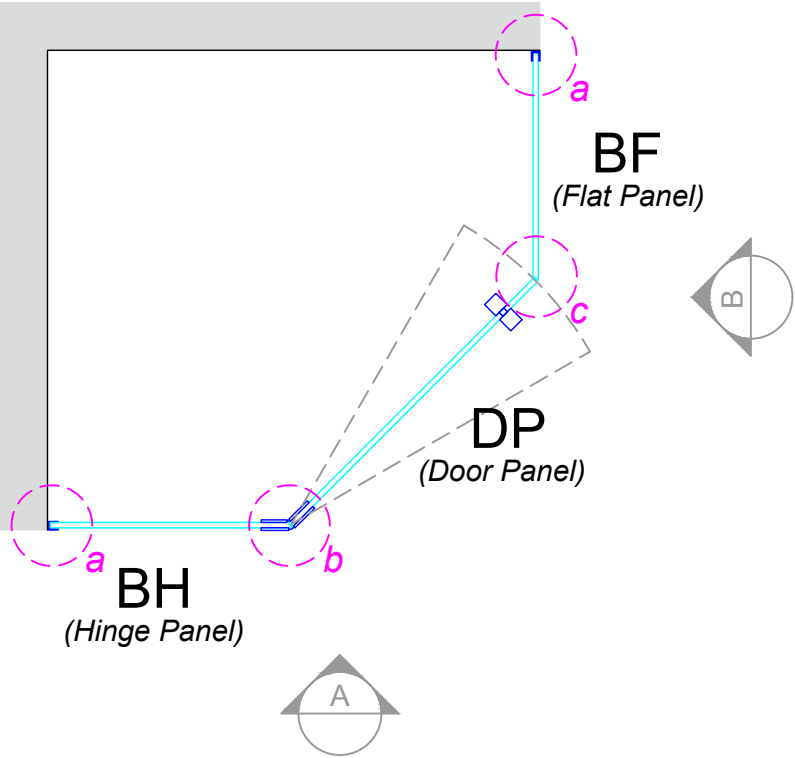

TOP VIEW

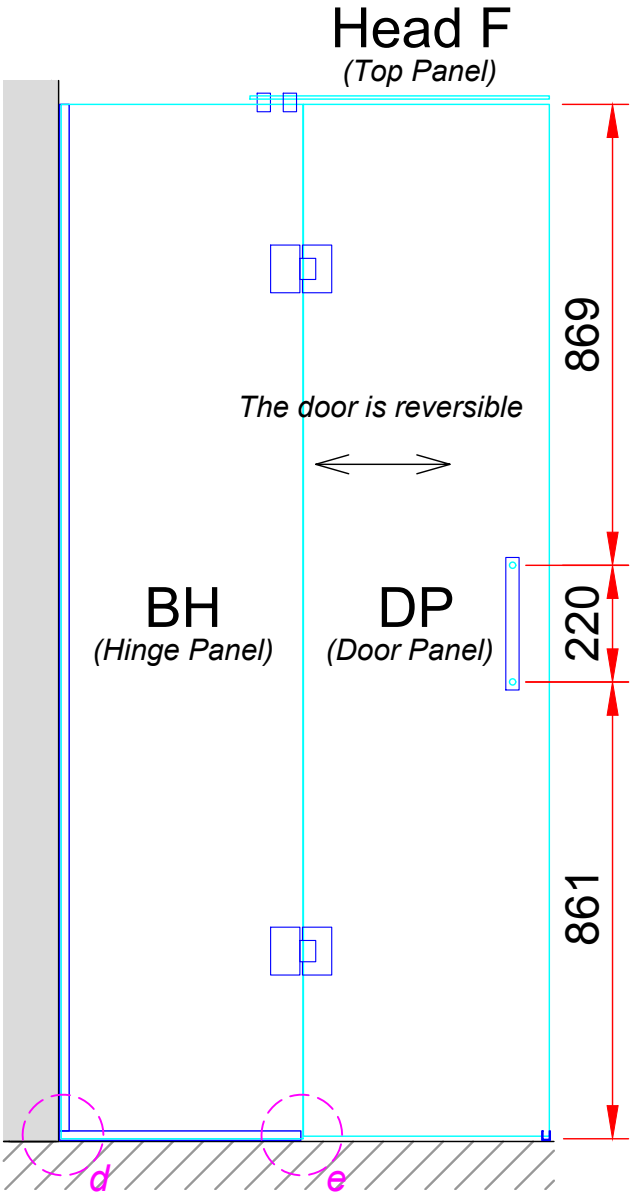

ELEVATION A

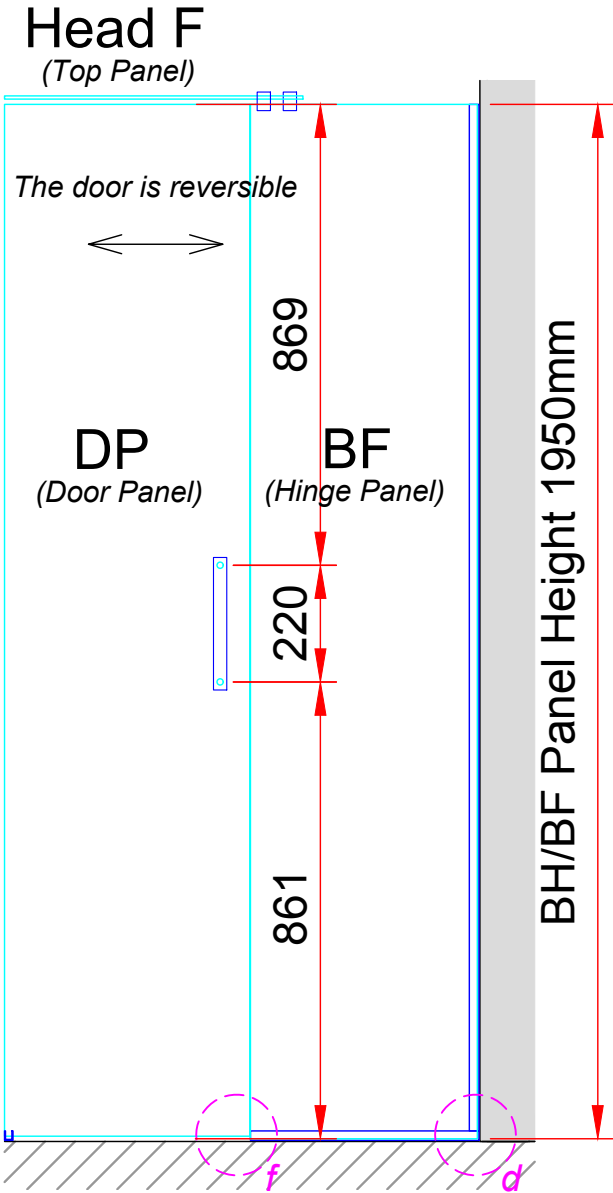

ELEVATION B

Important:

Before you install your project, please read this installation guide carefully, consider the gap between each part, calculate the exact length before cutting.

The corners and edges of toughened glass are its weakest points, so ensure they are well-protected during installation.

Always use rubber spacers to separate stainless steel hardware from the glass to avoid damage.

After completing the installation, it is essential to clean both the glass and the hardware. Proper cleaning of the glass helps maintain its protective coating, and cleaning the hardware removes any metal debris from the installation process, preventing potential rust.

Additionally, regular cleaning afterward is recommended to ensure long-term durability and maintain optimal performance.

LEGEND

BH	Hinge panel with bevel edge
BF	Flat panel with bevel edge
DP	Door Panel
a	Gap between wall and glass panel
b	Gap between hinge and door panel
c	Gap between flat and door panel
d	Channel Joint
e	Channel, glass panel, and door
f	Flat panel 90° joint

For more detailed information, please contact the team: email [sales@grandglass.co.nz](mailto:sales@grandglass.co.nz) ph 09 478 9778 or 027 755 7705 [www.grandglass.co.nz](http://www.grandglass.co.nz)



ADD: 18a Parkway Drive, Rosedale. PH: 09 478 9778 , 027 755 7705

Grand Glass Angle Shower Installation Guide

Complies with NZS3604:2011

Drawn By : SW	Date : 1/29/2025	Paper Size : A3
Checked By : JQ		Scale : NTS
Drawing No. : GGH-AS01		Rev. No. : 0
		Sht. No. : 1

Fixing Detail

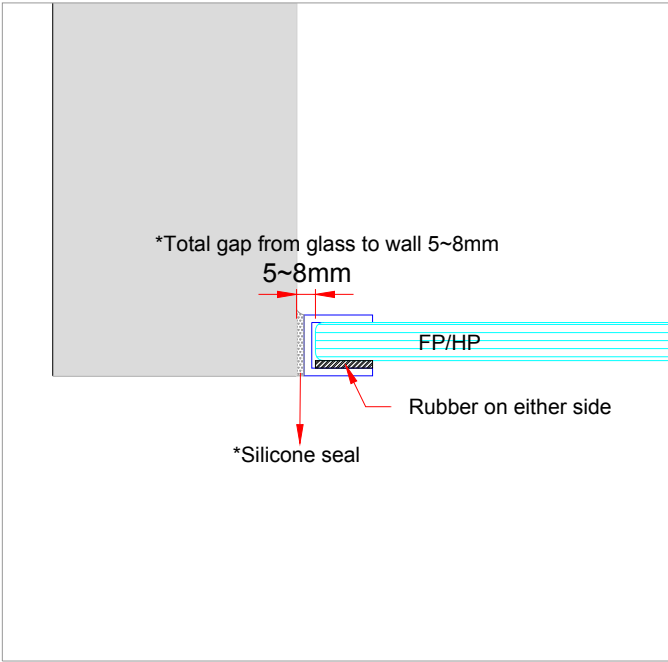

FIXING DETAIL a

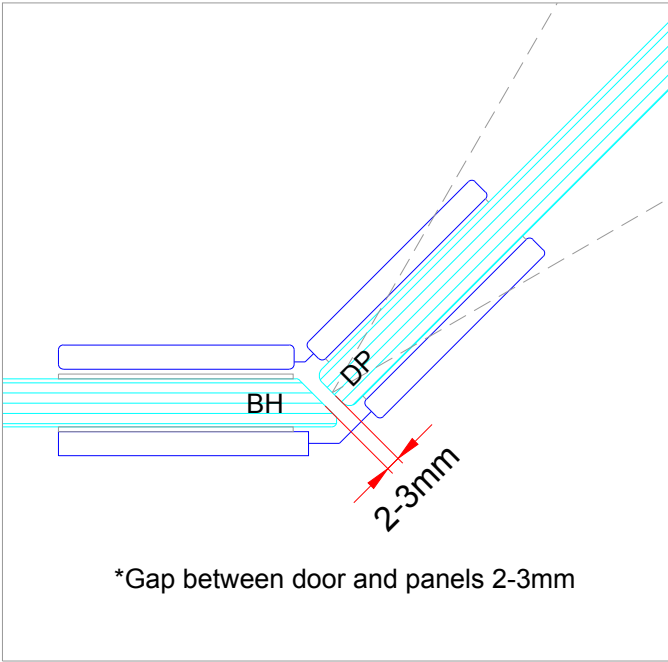

FIXING DETAIL b

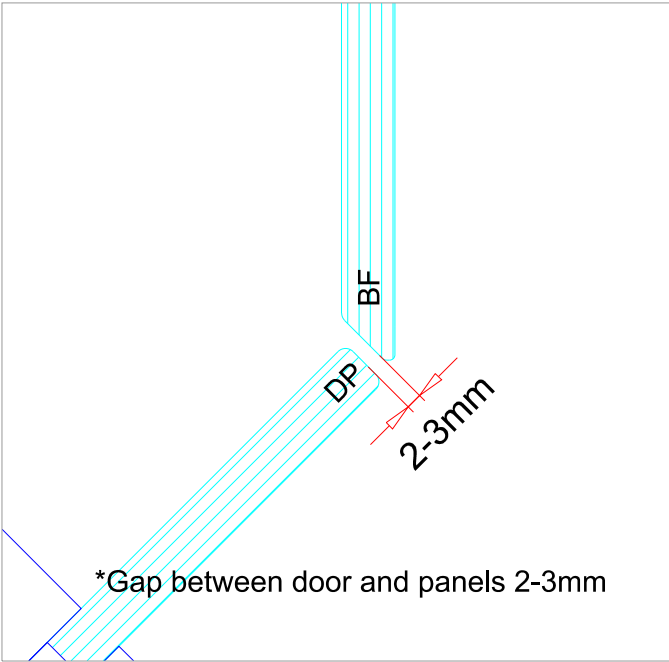

FIXING DETAIL c

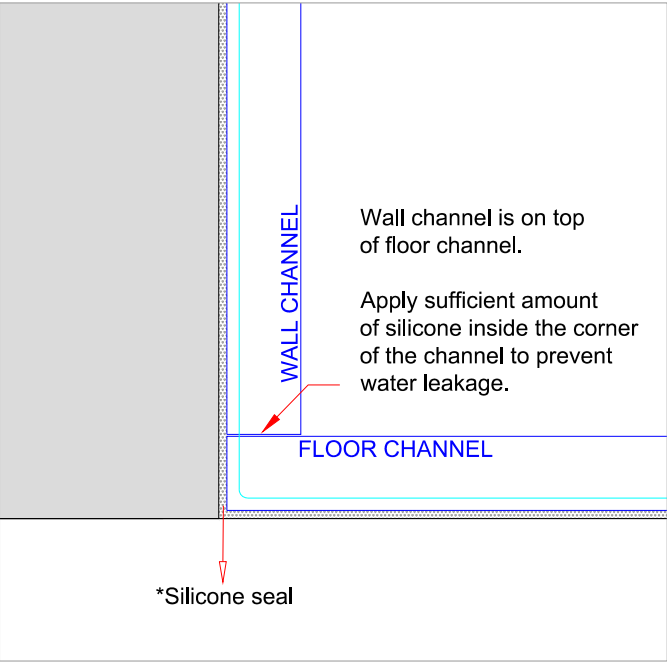

FIXING DETAIL d

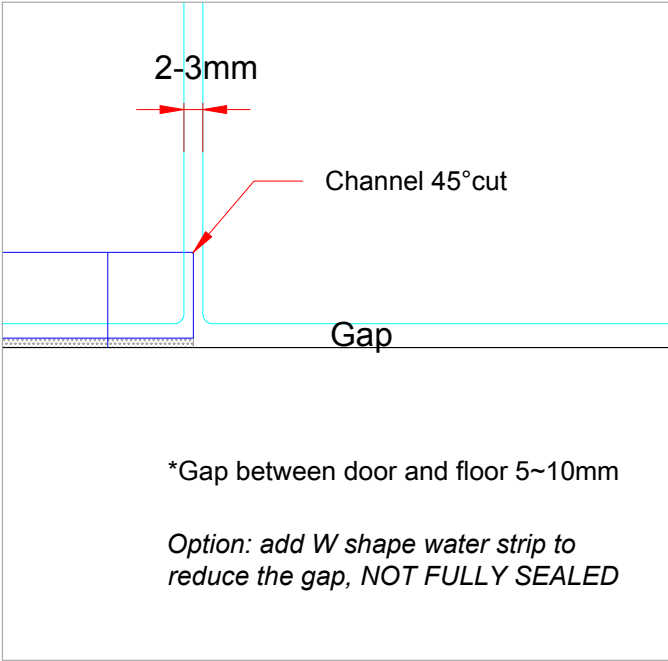

FIXING DETAIL e

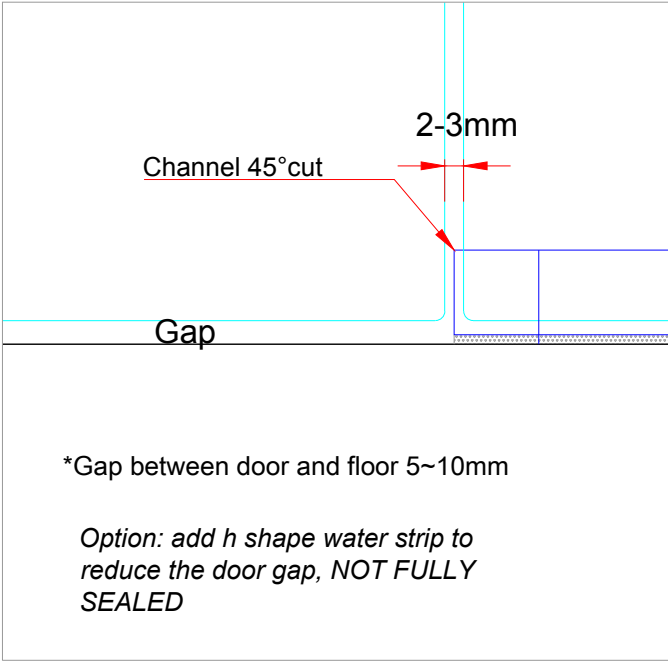

FIXING DETAIL f

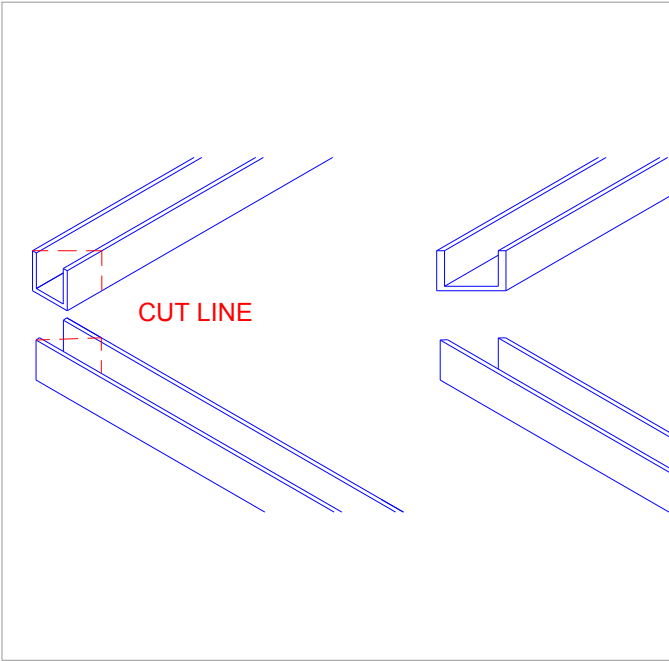

CHANNEL 45° CUT